



# HOLKER ESTATES CO LTD

The Estate Office, Cark-in-Cartmel, Grange over Sands, Cumbria LA11 7PH  
Tel: 015395 58313

## Old Park Wood Permissive Access Scheme

SCALE :  
1 : 11000







DATE :  
17/07/2019

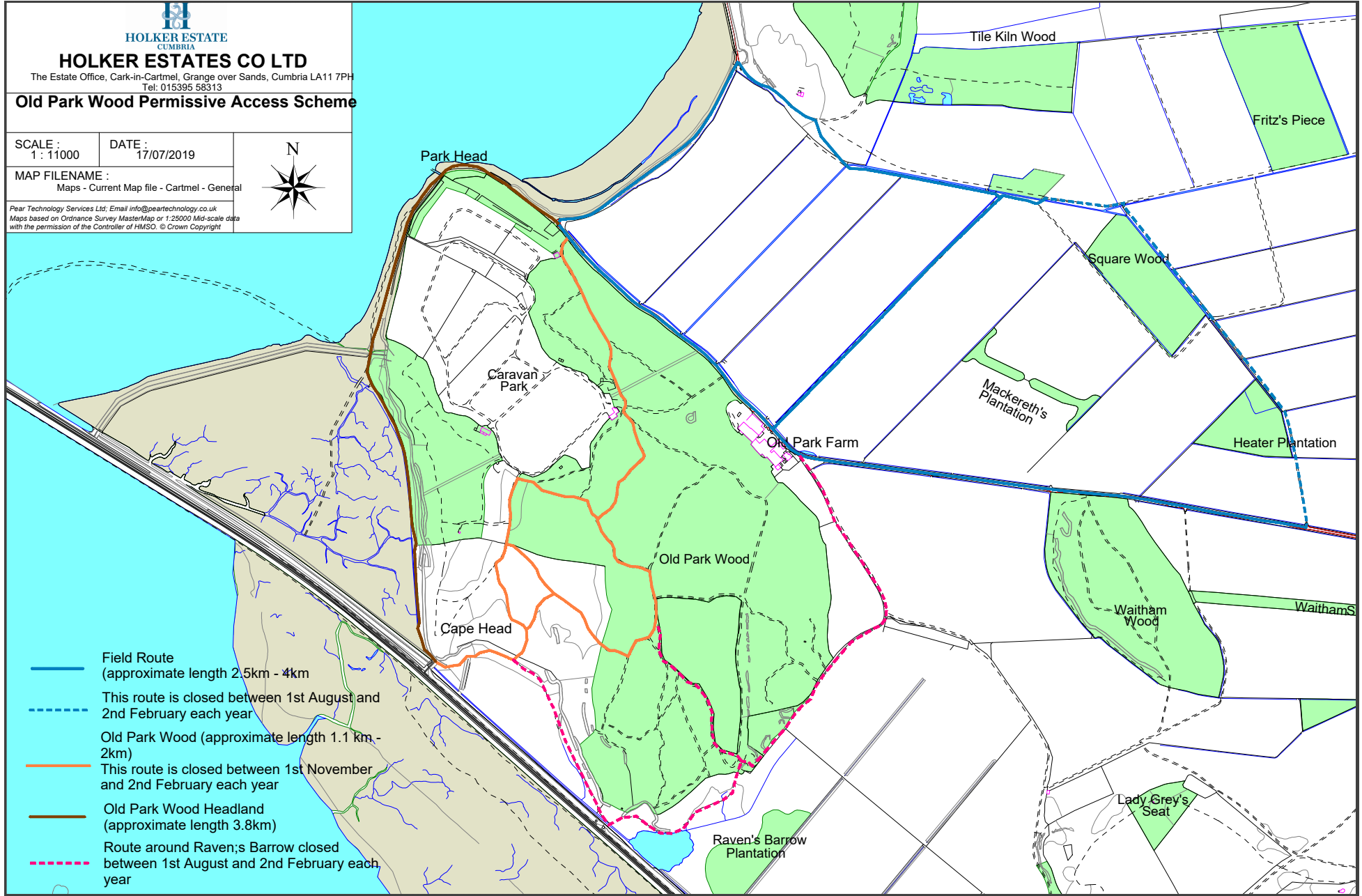

MAP FILENAME :  
Maps - Current Map file - Cartmel - Genetal

Pear Technology Services Ltd: Email info@peartechology.co.uk  
Maps based on Ordnance Survey MasterMap or 1:25000 Mid-scale data  
with the permission of the Controller of HMSO. © Crown Copyright



-  Field Route  
(approximate length 2.5km - 4km)
-  This route is closed between 1st August and 2nd February each year
-  Old Park Wood (approximate length 1.1 km - 2km)
-  This route is closed between 1st November and 2nd February each year
-  Old Park Wood Headland  
(approximate length 3.8km)
-  Route around Raven's Barrow closed between 1st August and 2nd February each year